

# Piastra di scorrimento autolubrificante a norma VDI 3357

Wear plate self-lubricating VDI 3357

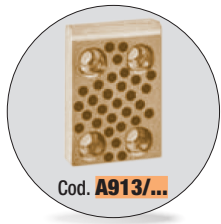

Sede viti	t	Ød	ØD
M8x25	+0,5	H13	H13
M12x25	9	9	15
	13	13,5	20

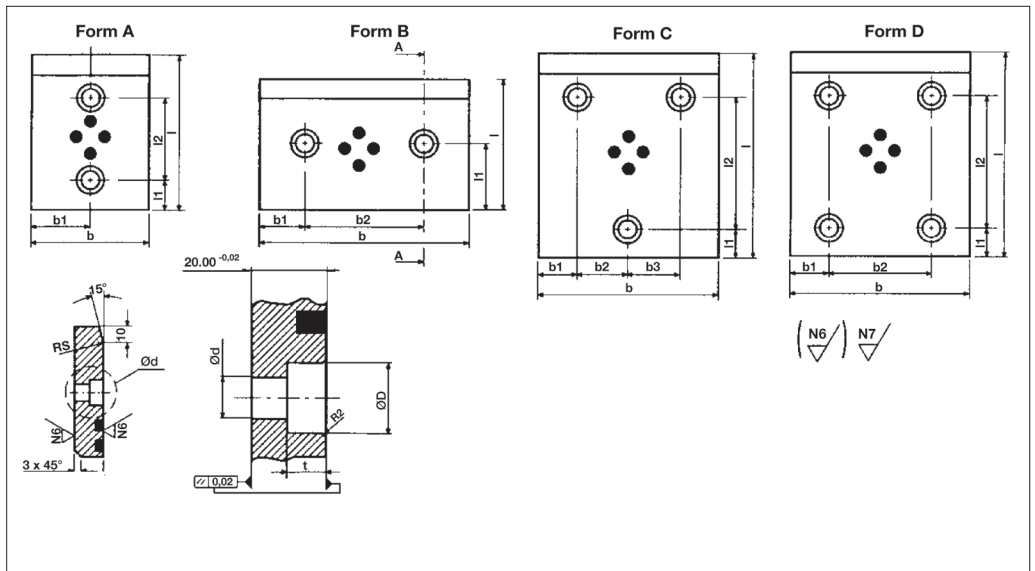

<b>Codice</b>	Cod. <b>A913/...</b>
<b>Materiale</b>	Bronzo + grafite / HB≥190

<b>Codice</b>	Cod. <b>A915/...</b>
<b>Materiale</b>	16MnCr5 / HRC 58-60

Codice	Codice	b x l	b <sub>1</sub> ± 0,1	b <sub>2</sub> ± 0,1	b <sub>3</sub> ± 0,1	l <sub>1</sub> ± 0,1	l <sub>2</sub> ± 0,1	FORM	Viti DIN 912	NUMERO VITI
A913/50 x 80	A915/50 x 80	50 x 80	25,0	-	-	25	30,0	A	M8x25	2
A913/50 x 100	A915/50 x 100	50 x 100	25,0	-	-	25,0	50,0	A	M12x25	2
A913/50 x 125	A915/50 x 125	50 x 125					75,0			
A913/50 x 160	A915/50 x 160	50 x 160					110,0			
A913/50 x 200	A915/50 x 200	50 x 200					150,0			
A913/80 x 50	A915/80 x 50	80 x 50	25,0	30	-	25,0	-	B	M8x25	2
A913/80 x 80	A915/80 x 80	80 x 80	40,0	-	-	25,0	30,0	A	M12x25	2
A913/80 x 100	A915/80 x 100	80 x 100					50,0			
A913/80 x 125	A915/80 x 125	80 x 125					75,0			
A913/80 x 160	A915/80 x 160	80 x 160					110,0			
A913/80 x 200	A915/80 x 200	80 x 200					150,0			
A913/*80 x 250	A915/*80 x 250	*80 x 250	40,0	-	-	40,0	170,0	A	M12x25	2
A913/*80 x 315	A915/*80 x 315	*80 x 315					235,0			
A913/100 x 50	A915/100 x 50	100 x 50	25,0	50	-	25,0	-	B	M12x25	2
A913/100 x 80	A915/100 x 80	100 x 80	50,0	-	-	25,00	40,0	A	M12x25	2
A913/100 x 100	A915/100 x 100	100 x 100					50,0			
A913/100 x 125	A915/100 x 125	100 x 125					75,0			
A913/100 x 160	A915/100 x 160	100 x 160					110,0			
A913/100 x 200	A915/100 x 200	100 x 200	150,0							
A913/*100 x 250	A915/*100 x 250	*100 x 250	50,0	-	-	40,00	170,0	A	M12x25	2
A913/*100 x 315	A915/*100 x 315	*100 x 315					235,0			
A913/125 x 50	A915/125 x 50	125 x 50	25,0	75,0	-	25,0	-	B	M12x25	2
A913/125 x 80	A915/125 x 80	125 x 80	25,0	37,5	37,5	25,0	50,0	C	M12x25	3
A913/125 x 100	A915/125 x 100	125 x 100					75,0			
A913/125 x 125	A915/125 x 125	125 x 125					110,0			
A913/125 x 160	A915/125 x 160	125 x 160					150,0			
A913/125 x 200	A915/125 x 200	125 x 200	150,0							
A913/*125 x 250	A915/*125 x 250	*125 x 250	25,0	37,5	37,5	40,0	170,0	C	M12x25	3
A913/*125 x 315	A915/*125 x 315	*125 x 315					235,0			
A913/160 x 50	A915/160 x 50	160 x 50	25,0	110,0	-	25,0	-	B	M12x25	2
A913/160 x 80	A915/160 x 80	160 x 80	25,0	55,0	55,0	25	40,0	C	M12x25	3
A913/160 x 100	A915/160 x 100	160 x 100					50,0			
A913/160 x 125	A915/160 x 125	160 x 125					75,0			
A913/160 x 160	A915/160 x 160	160 x 160					110,0			
A913/160 x 200	A915/160 x 200	160 x 200	150,0							
A913/*160 x 250	A915/*160 x 250	*160 x 250	25,0	110,0	-	40	170,0	D	M12x25	4
A913/*160 x 315	A915/*160 x 315	*160 x 315					235,0			

Esempio di ordinazione/Order example = A913/100x200 (Codice)

\* Dimensioni non a norma VDI. Size not in accordance with VDI.